

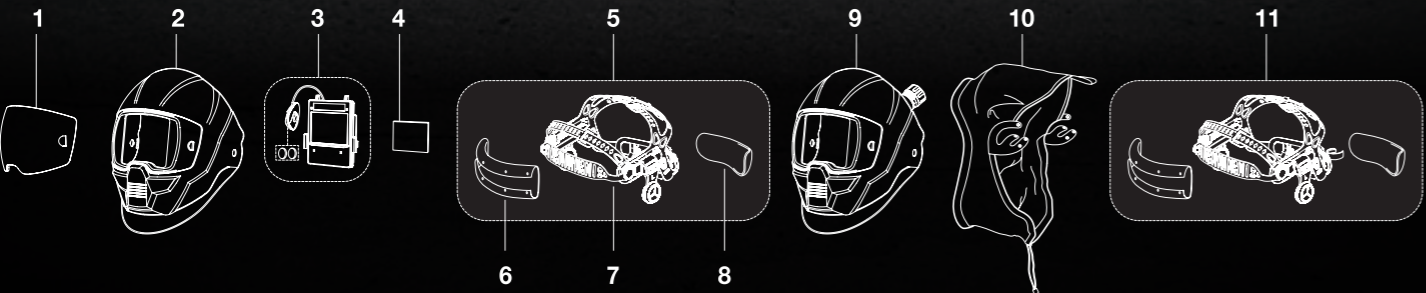

INDUSTRY
Industrial and General Fabrication

SPECIFICATIONS	
Cartridge Dimensions	133 x 114 x 9 mm
Viewing Area	100 x 60 mm (3.93" x 2.36")
QSet™	An Intelligent welding system that monitors the welding arc and optimises welding parameters.
Lens Shade	DIN 5-8/9-13
Power Supply	Solar cell plus replaceable battery. (2 x CR2450 lithium). Alerts when low battery.
Sensors	4
Switch Time	1/25,000 s. from Light to Dark
Optical Classification	1/1/1/2
Standards	AS/NZS1337.1, AS/NZS1338.1, DIN plus, CE, EN175, EN 379, EN166, ANSI Z87.1, CSA Z94.3.

- APPLICATIONS**
- Low Amperage TIG Rated: ≥ 2 amps (DC); ≥ 2 amps (AC)
 - Stick Welding (MMAW);
 - TIG DC&AC; TIG Pulse DC; TIG Pulse AC;
 - MIG/MAG/CO₂; MIG/MAG Pulse;
 - Plasma Arc Cutting (PAC); Plasma Arc Welding (PAW);
 - Air Carbon Arc Cutting (CAC-A);
 - Oxyfuel Gas Welding (OFW);
 - Oxygen Cutting (OC);
 - Grinding



ORDERING INFORMATION	
Sentinel A50	0700 000 800
Sentinel A50 Air COMING SOON	0700 000 801

WEAR AND SPARE PARTS	
1 Front Cover Lens Clear (1 x Pack of 5)	0700 000 802
1 Front Cover Lens Amber (1 x Pack of 5)	0700 000 803
2 SENTINEL Helmet Shell (For A50 only)	0700 000 804
3 Auto-Darkening Filter (Incl. 2 x CR2450 lithium)	0700 000 806
4 Inside Cover Lens 100 x 64mm (1 x Pack of 5)	0700 000 808
5 Headgear Assembly (For A50 only) (Including Sweat Bands)	0700 000 809
6 Front Sweat Band (1 x Pack of 2)	0700 000 810
7 Headgear (For A50 only)	0700 000 811
8 Rear Sweat Band (1 x Pack of 2)	0700 000 812
9 SENTINEL A50 Air shell with air duct (For A50 Air only) COMING SOON	0700 000 813
10 Face Seal and Bracket (For A50 Air only) COMING SOON	0700 000 814
11 Headgear Assembly (For A50 Air only) (Including Sweat Bands) COMING SOON	0700 000 805

RESPIRATORY OPTIONS

Sentinel comes in two versions. There is the standard helmet (Sentinel A50) and the air version (Sentinel A50 Air **COMING SOON**), which has hoses and connections ready to fit ESAB's range of powered air respirators.

SENTINEL™ A50

Years of welding have trained you to know exactly what you need in a hood: crucial comfort, large lens, and next generation technology. Every special operation needs special equipment that gets the job done, and when it comes to your helmet, SENTINEL™ is worn by the best.

HELMET & HARNESS

- High Impact Revolutionary Shell Design.
- Resistance Nylon and soft touch matte paint finish.
- Halo™ Headgear: Ergonomic, infinitely-adjustable 5 point head gear provides extreme comfort and balance.
- Low-profile design, central pivot point allows for maximum head clearance while helmet is in the up position.
- Externally activated Grind Button. (Shade 3 Grind Mode).

ADF, TOUCH SCREEN & VISIBILITY

- 4 Sensors
- 5-13 Auto Darkening Filter (Optical Class: 1/1/1/2)
- Switching time: 1/25,000s
- Large 100 x 60mm viewing area
- Crystal Clear True Colour Visibility
- Colour touch screen control panel – with 8 x memory locations
- Arc Hours tested above 2000+ with replaceable batteries Lithium ion CR2450

COVER LENS

- Quick release front cover lens: Front cover lens replaceable within 10 seconds, without removing helmet (front loaded).
- Hard Coated Anti-Scratch front cover lens – Clear and Amber options.



Tel: 1300 654 674
Email: enquiries@cigweld.com.au
CIGWELD.COM.AU | ESAB.COM



3 YR WARRANTY 3 YR Warranty on Auto Darkening Filter*
*For Full Warranty Details Refer Operating Manual

SENTINEL™ A50

When it comes to choosing a helmet, Sentinel is it — with ergonomic headgear, supreme comfort, large lens, intuitive controls, and crystal-clear visibility.

Ergonomic HALO™ headgear —

Sentinel's headgear was built from the ground up with a focus on ergonomics. The five-point-contact headgear is adjustable, so the weight of the helmet can be shifted around the head, which reduces pressure loads and increases comfort for long-term wear.



Intuitive touchscreen control —

Standard analogue buttons get an upgrade on Sentinel, which features a full-colour LCD touchscreen panel, similar to a smartphone's screen. This premium display will increase clarity for welders, and its intuitive controls and easy-to-use functions make clever technology simple.



Innovative shell design —

Welding hoods have looked the same for years. But no longer. Sentinel's streamlined shell design is not too big and not too small, accounting for a range of different head sizes and shaking up the aesthetics at the same time. The flush exterior also minimises extrusions, so nothing catches when working in a tight space.

Spherical front cover lens —

The sweeping design across the helmet allows more natural light to get in when welders are in grind mode, ultimately increasing visibility and clarity. Sentinel also comes with two lenses: A clear lens and a yellow lens, each of which is quickly and easily replaceable.

High-performance Auto-Darkening Filter (ADF) —

Sentinel redefines visibility for the welder with its high optical class ADF, allowing for a brighter view and enhanced colour definition. The light state grind mode provides superior convenience and can be accessed from an external button.

Sentinel's ultra-clear true-colour lens gives you a realistic view of your weld.



SENTINEL™ A50

AUTO FILTER

High optical class ADF, with colour touch screen interface

